



Control approach 1

Beauty salon – makeover, nails and depilatory services

SR13

General ventilation



This guidance sheet is for employers including the self-employed and franchisees

to help them comply with the requirements of the Control of Substances Hazardous to Health Regulations 2002 (COSHH) by controlling exposure to chemicals and protecting workers' health.

The sheet is part of HSE guidance *COSHH essentials: easy steps to control chemicals*. It describes the key points you need to follow to help reduce exposure to an adequate level. It is important to follow all the points, or use equally effective measures.

Get safety data sheets from your product supplier. Use these to identify the more dangerous chemicals, and less dangerous substitutes. Also check for flammability.

Solvent vapour can cause headaches, dizziness and nausea.

Dust and vapour from artificial nails can cause eye, nose and throat irritation.

Depilatory waxes, skin lighteners and nail polishes can cause itching, rashes and blistering (dermatitis).

General ventilation is the recommended approach.

Electrically powered equipment requires portable appliance testing (PAT).

Workplace and access

- ✓ Keep the workplace well organised, with clear exit routes.

Design and equipment

- ✓ Use sterile single-use instruments whenever possible.
- ✓ Keep the workplace well ventilated - 5 to 10 air changes per hour with a through draught.
- ✗ Never re-use a concentrate container. Dispose of it safely or return it to your supplier.
- ✗ Don't store more than 50 litres of flammable liquid indoors. Use a flammables store.
- ✓ You need washing facilities for decontamination after handling products.

Procedures

- ✓ Buy liquid chemicals in containers that are easy to pour from, don't dribble, and don't trap liquid in a rim.
- ✓ If possible, buy products in a ready-for-use solution.
- ✓ Store products containing chemicals securely in a cool, dry, dark place, capable of keeping in spills. Don't store far more than you need.
- ✓ Make up only as much solution as you will need for immediate use.
- ✓ Put the cap back on the container immediately.
- ✓ Clean up spills promptly - practise how to do this.
- ✓ Dispose of safely all products you no longer need.

Special care

- Some products may cause asthma - check the safety data sheet.
- Many products (eg depilatory waxes, nail polishes) contain colophony or rosin, which may cause dermatitis (itching, rashes, blistering).
- Nail sculpture using acrylic resins creates dust and vapour that can cause wheezing and chest tightness, and the resin can cause dermatitis.

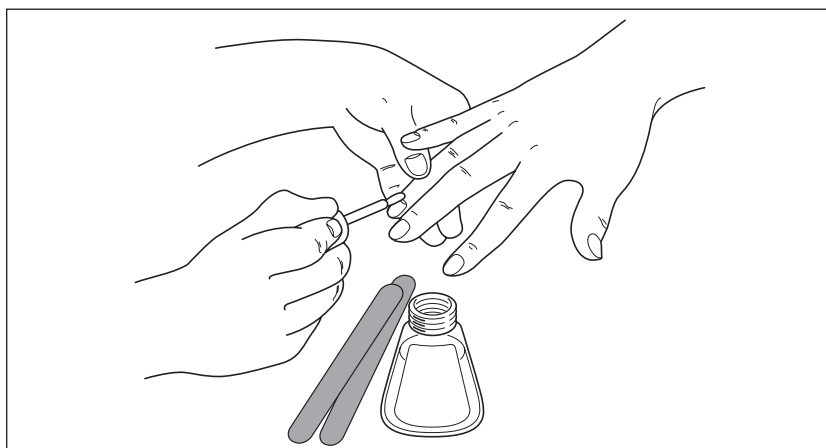

Maintenance

- ✓ Wash out mixing equipment after use. Dispose of this waste liquid safely.

Cleaning and housekeeping

- ✓ Keep the work area clean.
- ✓ Disinfect shower heads once a week.
- ✓ Clear up spills promptly. Provide granules to absorb spills, and a lidded bin to store this waste for disposal.

Personal protective equipment (PPE)

- ✓ Follow the instructions on product labels.
- ✓ Wear protective gloves - single-use nitrile gloves are acceptable. If you must use latex gloves, use only 'low-protein, powder-free' gloves.
- ✓ Throw away single-use gloves every time you take them off.
- ✓ Skin creams are important for skin protection and help in washing contamination from the skin. These are **not** 'barrier creams'. After work creams help to replace skin oils.

Health advice

- ✓ Ask your workers to check their skin for dryness or soreness every six months. If these effects appear, check the proper use of skin creams and PPE.
- ✓ If you use a product labelled 'may cause sensitisation by skin contact' or 'may cause sensitisation by inhalation', seek specialist advice. See Further information and Control guidance sheet 402.
- ✓ Consult an occupational health professional if workers report sore eyes, runny nose, coughing, wheezing or breathing difficulties that seem to be connected with work.

Training

- ✓ Show your workers this sheet and check that they understand it.
- ✓ Tell them about the risks of using the product - see product labels or Section 15 of the safety data sheet from your product supplier.
- ✓ Make sure everyone knows how to clear up spills promptly and safely.

Supervision

- ✓ Get safety data sheets from your suppliers and identify the more dangerous chemicals. Consider substitution.

Further information

- *Assessing and managing risks at work from skin exposure to chemical agents: Guidance for employers and health and safety specialists* HSG205
HSE Books 2001 ISBN 0 7176 1826 9
- *Preventing dermatitis at work: Advice for employers and employees*
Leaflet INDG233 HSE Books 1996 (single copy free or priced packs of 15 ISBN 0 7176 1246 5)
- Health and safety consultants: the BOHS Faculty of Occupational Hygiene keeps lists of qualified hygienists who can help you. Contact BOHS on 0133 229 8087 or at www.bohs.org/
- Occupational health professionals: details of doctors and nurses can be found in the Yellow Pages under 'Health and safety consultants' and 'Health authorities and services'. Also visit the NHS website at www.nhsplus.nhs.uk

Employee checklist

- Look for signs of leaks, wear and damage.
- If you find any problems, tell your supervisor. Don't just carry on working.
- Wash your hands after use, and before and after eating, drinking, smoking and using the lavatory.
- Never clean your hands with concentrated cleaning products or solvents.
- Clear up spills immediately. Absorb spills in granules and put them in a lidded bin.
- Throw away single-use gloves every time you take them off.
- Check your skin regularly for dryness or soreness - tell your supervisor if these symptoms appear.
- Use skin creams provided as instructed.



COSHH essentials:
easy steps to control chemicals
October 2003

Printed and published by
the Health and Safety Executive